

Located in Currumbin on the **Gold Coast, Queensland**, Soundlounge can be configured for 300, 500 or 700 guests.

Live music for over 10 years

Soundlounge offers modern production, excellent room acoustics, plus numerous capacity and seating options to create the best original live music venue on the Gold Coast.

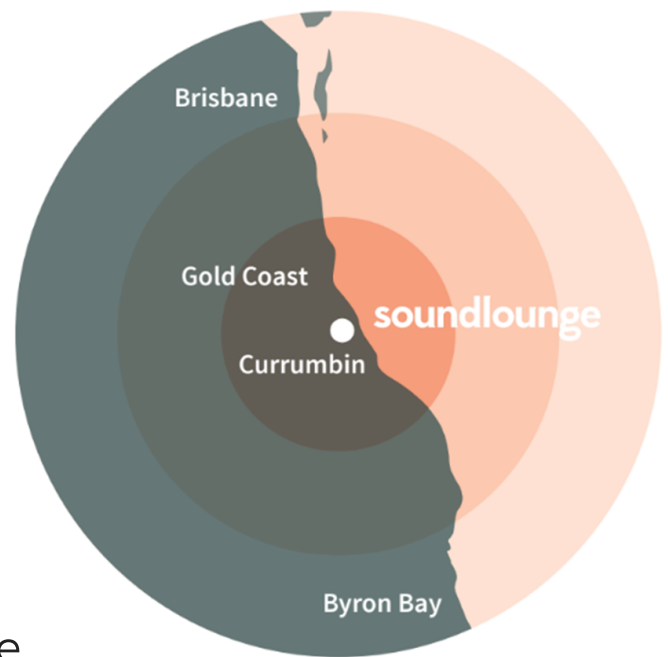

All about the music

We've had a diverse collection of popular Australian & international artists entertain our audiences since Soundlounge's first opening in 2004, with past performers including Sarah Blasko, Angus & Julia Stone, Passenger, Violent Soho, Boy & Bear, Eric Bibb, Emma Louise, Kate Miller - Heidke, J Mascis, In Hearts Wake and hundreds more.

Our mantra

Our purpose is to advocate original music, embracing all genres and artistic styles. At Soundlounge, we believe in supporting the live music scene locally, nationally and internationally. We endeavor to be the premier music venue on the Gold Coast.

Where we are

Soundlounge is located upstairs at Currumbin RSL on the Gold Coast, just 6km from the Gold Coast Airport, 2 minutes off the M1. Ideally situated between Brisbane and Byron, each only an hour's drive away. Soundlounge is a perfect destination as part of any national tour run.

Venue: Soundlounge
Address: 165 Duringan St, Currumbin, QLD 4223
Venue Phone: 07 5534 7999
Capacity: 700 standing | 300 seated

CONTACTS:

Band & Venue Contact: Caitlin Francis
Phone: 07 5534 0928
Email: caitlin@soundlounge.com.au

Sound Production: Peter Murtagh
Phone: 0411 595 615
Email: tech@soundlounge.com.au

FOH Sound Engineer: Joshua Whitney
Phone: 0402 428 464
Email: tech@soundlounge.com.au

Fold Back Sound Engineer: Chris Naughton
Phone: 0421 973 858
Email: tech@soundlounge.com.au

Follow us

We are a social bunch. follow us at:



facebook.com/soundlounge.com.au



instagram.com/soundlounge



twitter.com/thsoundlounge

Promotion

Soundlounge promotions are direct and effective, resulting in high awareness to a loyal clientele base that make up our social network and mailing list.

Our promotional efforts include:

- 10,000 quarterly programs distributed across 70km of the Gold Coast, from Tweed Heads to South Port
- Weekly emails sent to over 5000 subscribers
- 150 street posters circulated throughout the city
- A large and ever-growing following on Facebook, Instagram and Twitter
- On site digital signage at the Club
- Main road LED signage advertising upcoming shows
- Facebook competitions and advertising
- Listings in all major gig guides
- Program section in club publications reaching 25,000 quarterly
- Press releases sent to over 150 local media partners including, The Music, Blank magazine, Gold Coast Bulletin, Tweed Daily News, Byron Echo, Gold Coast Sun, ABC Coast FM and more

Capacity

Soundlounge's room provides a flexible space that can accommodate 300, 500 or 700 guests, depending on room configuration.

A backstage area is provided for artists, as well as Venue Manager, door staff and professional front of house, and fold back engineers,

Ticketing

Tickets are sold online exclusively via Soundlounge's website, Keeping booking fees to a minimum. Tickets are also available for purchase at the door if not sold out. Agents are provided a login to check ticket sales, worksheet details and financial reports for any artists they have booked with us, past or present,

Bookings

If you have questions regarding venue fees, or wish to enquire about anything, please feel free to contact:

Caitlin Francis

07 5534 0928

caitlin@soundlounge.com.au

Floorplan

Legend

- P Projectors
- ♿ Disabled Toilets
- S Speaker Stack

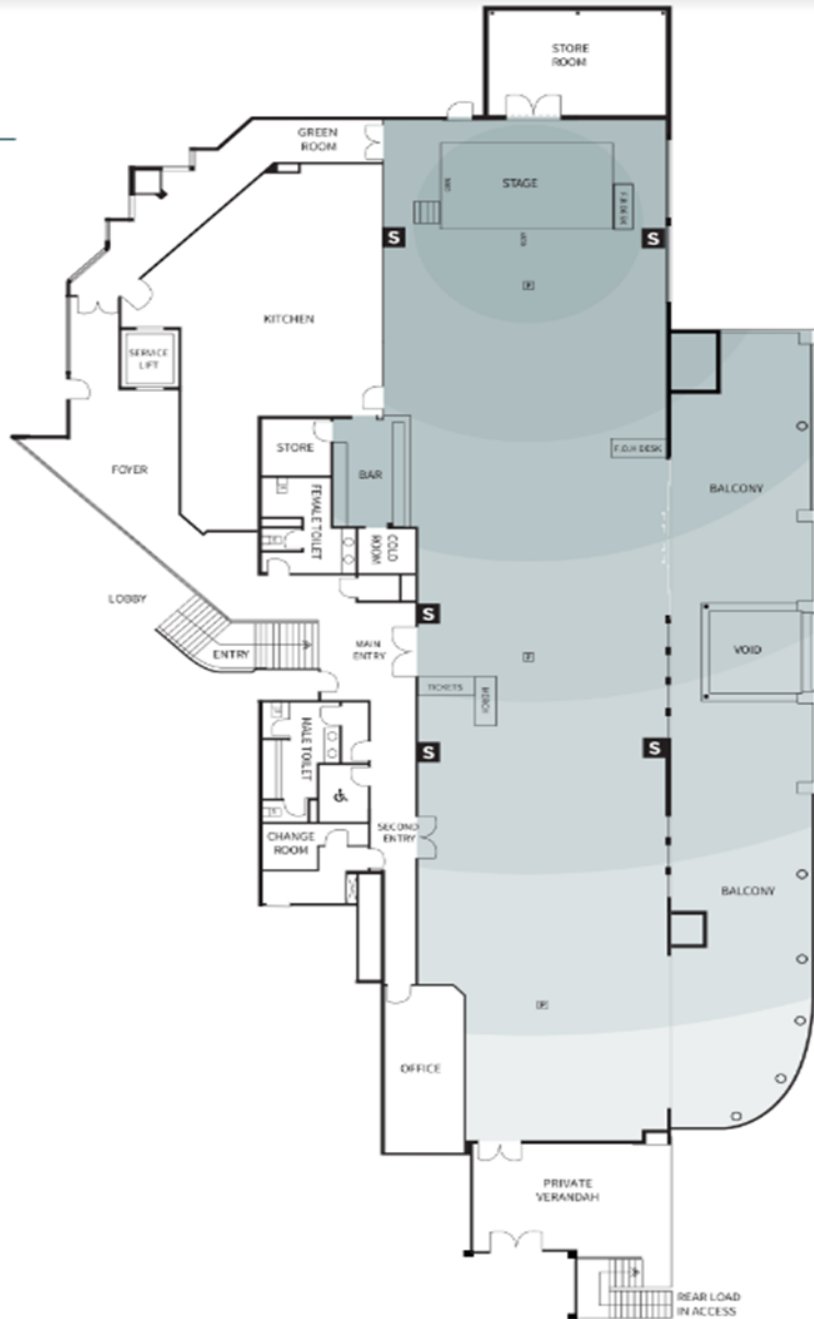

SOUNDLOUNGE PRODUCTION TEAM WILL PROVIDE:

1x Qualified Sound Engineer

1x Qualified Fold Back Operator

F.O.H Sound Reinforcement

4x Turbosound TXD252 Speakers 1000

Watts each 4ohm box

2x Yamaha SW215V Club Series V Dual 15"

Subwoofer 1000 watt's each 4ohm box

2x Yamaha CW218V Dual 18" Club Concert

Series Subwoofer 1200 Watts each 4ohm

box

Amplifiers & Crossovers

2x Quest QA3004 two channel Power Amps

1100W Per Channel @ 4ohm

2 x Behringer Europower EP4000 2 channel

Power Amp 1400W per channel @ 4ohm

1x DBX 223XL Crossover DBX Driverack PX

F.O.H Delay stack consisting of

2x Yamaha S215V Club Series V Speaker

1000 Watts each 4ohm box

Yamaha P7000S two channel Power Amp

1100W Per Channel @ 4ohm

2 X 1,000 watt bi-amped Sampson 18" bins

Foldback Sound Reinforcement

2 X 800 watt JBL STX815M (15" & 1"Horn)

4 x 400 watt Yamaha MS400 (15" & 2"Horn
biamped)

1 X 350 watt Turbosound TQ-310 (10" &
Horn)

4 X 600 watt PS12s copies

2 X 250 watt JBL Eons (15" & Horn bi-
amped)

1 X 2600 watt per channel, four channel
Seer

Audio amplifier

1 x 400 watt ACT wedges (15" & Horn) with
800 watt stereo amp

Drum Fill self-powered Yamaha 15" with
horn plus 15" Electrovoice sub

F.O.H. Rack - Default Console

1 X Digico D1 Mixing Console (with 32/8
Digirack, ref mic, Audio Tools)

1 X Klark Teknic 31 Band Graphic EQ

1 x TC Electronics D-Two outboard effects unit

1 x TC Electronics M-One outboard effects unit

1 X Yamaha SPX 990 outboard effects unit

1 X Lexicon PCM70 Outboard effects unit

2 x DBX 266XL Two Channel Compressor/Gate or
by prior arrangement

1 x Soundcraft Spirit 32 channel 8 bus analogue mixer
(Delivery/collection fee of \$150 applies)

Foldback Rack

1 X Yamaha LS9 32 Mixing Console (with ref mic, Audio
Tools

& wireless router) 6 X 31 Band Yamaha Graphic
Equalisers

Microphones

8 X Shure SM57s

3 x Shure Beta 98 with drum mounts

2 X Sennheiser 855s

6 X Shure SM58s

2 x Shure Beta 58s

1 X Shure SM87

1 X Shure Beta-52 (Kick Drum Mic)

1 x Rode NT4 Stereo condenser (OH)

1 X AKG C430 Condenser

2 X Audio Technica AT3035 condenser

1 X AKG C480

3 x EV 357s

3 x EV 257

1 x PZM

8 X DIs, including Radial JDI K & M Mic Stands

Lighting

LMS 12 Channel Lighting Desk

Jands WMX 12 Channel Dimmer rack

16 x Par 64 cans

16 x Par 56 cans

Winch-up lighting trees 6m lighting truss

SOUNDLOUNGE PRODUCTION TEAM WILL PROVIDE:

Optional Lighting

*Strand 818 follow spot available for \$75 delivered *

4 x Coemar 150 moving lights with separate desk/controller available for \$150 delivered

Power

3 Phase + 240v

Stage - 3.6m Deep x 4.8m Wide

32 Channel Multicore with fold-back split

In-house Back-line Hire

Vox AC30 CC2 guitar amp. \$50

Hartke HA4000 watt bass amp with two 4x10" 400 watt Hartke cabinets \$100

Vase Trendsetter 30 watt valve guitar amp with either a two Celestion Greenback speaker box or a one Celestion Greenback speaker box.\$30

Delivery \$30

External Backline suppliers available on request. (please advise in advance if more are required)

Power 3 Phase + 240v

Stage 3.6m Deep x 7.2m Wide

32 Channel Multicore with fold-back split



82B Minnie St, Southport, Qld 4215
Ph 07 55314448 Mbl 0411 595 615
info@able2.com.au
www.able2.com.au

Able Video handles the sound & lighting at The Sound Lounge and can also provide the following services, provided by professional engineers/camera operators/directors:

- 24 track 16 - 24bit, 44.1 - 96khz audio recording of your performance -\$400 inc GST. WAV Files are copied to your hard drive or we can purchase one for you & send by mail.
- Four camera 1080i HD video switch & record (+desk & ambient audio) - \$1,650 inc GST Includes a DVD and the HD video files to your hard drive or one we purchase for you.

We can also mix down your multitrack audio recording in our ProTools 9 studio and add the mix (or a mix you provide) under the vision and output a saleable live DVD/CD - \$POA.